



中原大學

Chung Yuan Christian University

2025 Newly Admitted Students Handbook

Through an academic foundation and a holistic education process, aiming to cultivate individuals with character, expertise, creativity, and a global perspective.



contents

- 01 Message from the President**
- 02 A Model of Holistic Education**
- 04 Information for New Students**
- 05 Dormitory Application and Check in**
- 06 Data Entry Area**
- 08 Tuition and Miscellaneous Fees**
- 10 Course Selection and Credits Waiver**
- 11 Student Health Examination**
- 12 Our Grants**
- 13 A different kind of CYCU**
- 16 Parental Online Enquiry**
- 17 CYCU Calendar for
Academic Year 2025-2026**
- 19 Freshmen Orientation Camp**
- 20 Life and Transportation**
- 21 Campus Maps**

Message from the President

Dear CYCU freshmen

Greetings and a warm welcome to the CYCU family! As the president of CYCU, it is a great honor to share this special moment with you and to accompany you on this meaningful and enriching journey.

CYCU is now in its 70th year since its establishment in 1955, inspired by a spirit of Christian love for the world. In recent years, the operation of CYCU has won many awards, including a 100% freshmen enrollment rate for the 5th consecutive year, being ranked No.1 in the national and private university for the 7th consecutive year (2018-2024 academic year), being ranked top in private comprehensive universities for the 9th consecutive year. In terms of academic accolades, CYCU was named the Favorite University for Business and the Corporate Favorite University Student by 1111 Job Bank and Global Views Monthly. CYCU also ranked first in graduates' employment rate and high salary for bachelor alumni by 104 Corporation. In 2025, we once again secured the top spot among all private universities in Taiwan in the Global Views Monthly ranking of 'Universities Most Favored by Employers.' We also ranked No. 1 among private universities in the categories of 'Most Favored by Non-Listed Companies' and 'Most Favored by the Information Technology Industry.'

CYCU takes pride in being a sustainable institution with a friendly campus, we were honored by the Ministry of Education in 2019 as an outstanding school and awarded with the "Friendly Campus Award" and "Characteristics School for Life Education Award." In 2023, we were once again awarded the "Friendly Campus Award," making us the first and only school in the nation to be awarded four consecutive times. In addition, CYCU was awarded the "National Sustainable in Education Awards" by the Executive Yuan in 2022 and ranked No.1 among all private Taiwan universities in the UK "QS World University Rankings: Sustainability 2023." The honors show that CYCU has proven our dedication to shouldering social and environmental responsibilities and our commitment to the future. These honors show that CYCU has transformed the core value of holistic education into core competitiveness, which is why it has received various recognitions from the Ministry of Education, business owners, and domestic and international assessments.



We firmly believe that education is not only an approach to exploring knowledge and technique but also the process of shaping one's character and searching for the meaning of our own life. Everyone is endowed with different talents and personalities, abilities, and circumstances; therefore, to realize one's full potential is considered a success. Here at CYCU, you will encounter a wealth of academic resources and a vibrant array of campus activities. We believe that every student is unique, with distinct talents and abilities, and Chung Yuan Christian University is the stage where you can fully realize your potential.

Dear CYCU freshmen, your journey is about to begin. We look forward to seeing you grow through a fulfilling and meaningful university experience, one that will broaden your horizon, deepen your knowledge, and prepare you to become a driving force for positive change in society. Let's support and encourage one another along the way. You got this!

Yours sincerely,

In-Ming Lee



A model of holistic education



The excellence-ranked university in the world, surpassing the national top university

- ★ Ranked No. 1 private comprehensive university for the 6th consecutive year in the Center for World University Rankings (CWUR)
- ★ Ranked No.1 in Chemical Engineering and Polymer Science in the nation in U.S. News 《U.S. News》
- ★ Topping the list among private institutions in subject-specific rankings by the Times Higher Education (THE)



CYCU came out among the top university in academic influence, surpassing the national top university

- ★ The model of Category Normalized Citation Impact (CNCI) in 2022:
Value exceeding 1, surpassing the global average.
Ranked No.1 comprehensive university in the field of Environmental and Ecological Studies
Ranked No.1 private comprehensive university nationwide in Material Science



No.1 private school in employment rate and high salaries for alumni

- ★ 104 Corporation ranked CYCU as the No.1 private comprehensive university in the employment rate of graduates
- ★ 104 Corporation ranked CYCU as the private comprehensive university with the highest percentage of alumni salaries above \$80,000



The highest financial subsidy in Higher Education SPROUT Project for private university

- ★ Received the first prize for the Funding Direction Regarding the Development Plan for Private Universities for the seventh consecutive year, breaking the university record in the nation
- ★ The highest financial subsidy in MOE Higher Education SPROUT Project for private comprehensive universities in 2020 、2022 、2023.



CYCU is Trustworthy by Students and Parents Quality University with Faith, Hope, and Love



The university with the highest enrollment rate and retention rate

- ★ 100% enrollment rate of freshmen for the 2024 academic year and 100% enrollment rate for the 5th consecutive year
- ★ Ranked No.1 in national and private comprehensive universities in the nation for the 7th consecutive year
- ★ Ranked No.1 in private comprehensive universities for the 9th consecutive year
- ★ Reached 100% enrollment for University Distribution Admissions in the 2024 academic year



No. 1 private school in the industry-academia partnership, comparable to national universities

- ★ Awarded the Industry-Academia Partnership Award by the Chinese Institute of Engineers for the 7th consecutive time, ranked No.1 private university
- ★ The only university in Taiwan awarded International Creative Institution by the Ministry of Economic Affairs
- ★ Awarded the Outstanding Creative Institution by the Small and Medium Enterprise Administration (MOEA) for 12 times
- ★ Awarded two gold, one silver, and one bronze awards at The German Nuremberg Invention Exhibition



No. 1 friendly and sustainable campus in the nation

- ★ Awarded the National Sustainable Development Awards by the Executive Yuan in 2022
- ★ Ranked No.1 among all private Taiwan universities in the UK “QS World University Rankings: Sustainability 2023.”
- ★ 2009, 2014, 2019, and 2023 awarded the “Friendly Campus Award” for the four consecutive times by the Ministry of Education, breaking the national record

1.Information for New Students

Student ID



Please scan the QR Code on the right for the student ID or more information.

iTouch for Freshmen

<https://fm.cycu.edu.tw/> Learn more about CYCU and complete all the information.

iTouch <https://www.cycu.edu.tw/> → I-TOUCH

1.Open an Account:

The account number is the student number, and the password is preset to 8 codes for the birthday of the West. (Example: 20020102) Please reset the password after login. The password is valid for six months, and would be reset if the password is not modified within six months.

2.Connect Account and Password with Cellphone:

CYCU Website/CYCU Current Students/Personal Information/Account Security Settings

3.Function Description:

Students can access personal information, for example, basic personal registration, courses, course selection, exams, grades, leave of absence, etc.



✓ Self-checklist

Dormitory Application

☐ Student Housing Division #2191
Second Batch 8/1-8/20

Completing Data Entry Area

☐ Student Advising Division #2128
Open in 4/7

Applying for Student ID Cards

☐ Registration and Curriculum Division #1178
before 8/18 12:00 pm

Credit Waiver

☐ Registration and Curriculum Division #2026
8/1-9/10

Paying for Tuition and Miscellaneous Fees

☐ Cashier Division #2224
8/4-8/31

Courses Selection

☐ Please contact each department's office
9/4-9/6

Dormitory Check-in

☐ Student Housing Division #2191
8/30-8/31

Residential Orientation

☐ Student Housing Division #2191
9/1-9/2

Freshmen Orientation Camp

☐ Student Advising Division #2114
9/1-9/3

Student Health Examination

☐ Health Services Division #2162
before 9/30

TEL (03)265+extension number

2. Dormitory Application and Check in

Dormitory Application

03-2652191 Ms. Yu



Please scan the QR Code to apply for the dormitory before the deadline.

The Second Batch Application | August 1st - August 20th

1. The bed is assigned according to the Regulations for Student Dormitory Management and will not be affected by the order of application.
 2. Announce the second batch of approved dormitory list at 17:00 on August 21st.
- ★ Enquiry: CYCU Website → CYCU Current Students → Administrative Proclamation → Announcement of Approved Dormitory List

Dormitory Deposit Payment

1. Second Batch Deposit Payment: From August 22nd to August 29th.
2. The tuition fees bill only includes the dormitory fee and air-conditioning prepayment. The dormitory deposit must be paid separately by scanning the QR code provided.
3. Overseas students may pay the housing deposit after moved in. If the payment is not completed within one week after moving in and is not paid after reminder, the student will be notified in writing for confirmation. Student will be disqualified from priority housing in the following academic year and will be listed as a written replacement for the bed.

Dormitory Check-in Time | from 9 am to 5 pm

August 30th College of Engineering, College of Humanities, College of Law, College of Design

August 31st College of Science, College of Electrical Engineering and Computer Science, College of Business

- ★ To avoid traffic jams on campus, it is recommended that the students who live in Northern Taiwan register in the morning, and those who live in Southern Taiwan register in the afternoon.
- ★ Uploading English name and headshot before August 18th at noon to receive the student ID card upon check-in dormitory.
- ★ Access to the Hsin Shih Hall and Re Cheng Hall is managed centrally, so no entry pass is needed.

Residential Orientation

All residents should attend the residential orientation held at Chih Hsin Hall.

Li Hsing Hall

September 1st, 6:00 pm

(Boys' Dormitory) 03-2658105

En Tzu Hall

September 2nd, 6:00 pm

(Girls' Dormitory) 03-2658403

Lian Shan Hall

September 2nd, 7:30 pm

(Girls' Dormitory) 03-2657403

3.Data Entry Area

1 Go to the Website and Fill out the Data



Data Entry Area

Beginning on April 7th <https://fm.cycu.edu.tw/>

STEP 1 | Data Entry Area



STEP 2 | Log in

[Login] Please enter your login name and password. For new enrollees, the login name means the student ID, and password the 8 digits of the birth date.

• Start filling in time : 2023-08-01 00:00

Login Name: Password: **Login**

[Inquiry for Student ID](#) [Forgot password?](#)

[一般生中文介面](#)

★ The account number is the student number, and the password is preset to 8 codes for the birthday of the West.

STEP 3 | The Data Completion Form

Help
Teacher's words
Contact
Please click each step below to fill in.

1. Living Data Sheet
2. Application for Student ID Card
3. Application for Financial Account
4. Upload Autobiography
5. Setup of External Email
6. Health Information
7. Life Attitudes Survey
8. Summary Table
Logout

Information filling time : 2025-04-07 ~ 2025-10-15
The "Summary Table" is a required information for new students. After filling in, please confirm whether the status of each item is "green tick V". If you have any questions, please call the case office and ask.

State	Item	Case Office	Schedule
X	Living Data Sheet	Student Advising Division 03-2652128 test	4/7~9/30
X	Application for Student ID Card	Curriculum and Registration Division 03-2651178	4/7~8/18 12:00
X	Application for Financial Account	Cashier's Office 03-2652222	4/7-9/30
X	Upload Autobiography	Student Advising Division 03-2652124	4/7-9/30
X	Setup of External Email	Office of Information Technology 03-2651999	4/7-10/31
X	Health Information	Health Services Division 03-2652162	4/7~10/31
X	Life Attitudes Survey	Chaplain's Office 03-2652603	4/7~9/30

The freshmen need to complete all the forms in the Data Completion Form and make sure each section is complete. Feel free to contact the responsible division if there is any question.

2 Completing All the Information in the Data Entry Area

Student personal information in the Data Entry Area is collected for the purpose of contacting students. Student personal information will only be used in school administration and activities. Please follow the description in iTouch for freshmen to fill out and update the information in the Data Entry Area.

The information includes Uploading Educational Background Information for high school or vocational school, Life Information Sheet, Dormitory Application, Student ID Application, etc.

- ★ In order to defend personal rights, please make sure the information is correct and complete before submission.

Operating time : 27:58 [Retime](#) [Logout](#)

Help
Teacher's words
Contact
 Please click each step below to fill in.

1. Living Data Sheet
 2. Application for Student ID Card
 3. Application for Financial Account
 4. Upload Autobiography
 5. Setup of External Email
 6. Health Information
 7. Student Life Attitudes Survey
 8. Summary Table

[Logout](#)

Fill in the operating instructions

Welcome to use the CYCU freshman data filling system.
 The information will be used as the report and basis for the registration of your school registration information during the school year. **Please be sure to fill it out.**
 If you have any questions, please contact the organizer.
 ~~~~The information you fill in will be protected by relevant laws and regulations.~~~~

Homepage Notes:

1. In the life information form: Clicking the "Save" button only stores the data in the temporary database, and you can still modify it within the specified period. If you click the "Confirm and Send" button, it means you have completed filling out the form and confirmed that all the information will no longer be modified. Please double-check before clicking "Confirm and Send".

2. The system has a time limit of 30 minutes for filling out the form. If the time is exceeded, the system will automatically log out. If you haven't completed filling out the form, you can either log in again or click "Restart Timer".

### Student ID Application Registration and Curriculum Division 03-2651178 Ms. Huang

Uploading English name and headshot \*File format: 2M or less clear image file (\*.jpg)

- ★ Completing the application by 12:00 on August 18 (inclusive) can receive the student ID card in dormitory or Dickson Lee Hall 1F at dormitory moving day.
- ★ Completing the application after 12:00 on August 18 can receive the student ID card at Administration & services Center (Dickson Lee Hall 1F) after September 22.

## 4. Tuition and Miscellaneous Fees

### 1 Instructions for Paying Tuition and Fees

---

03-2652224 Ms. Shen

Download method for registration bill (includes payment certificate): scan the QR Code on the right side.

★ Log in the Tuition and Fees Area to check the charge standard.



### 2 Payment Deadline

---

Finish paying tuition and fees from August 4, 2025, to August 31, 2025.

1. Students who apply for the dormitory at **the first stage** shall download the payment slip on **August 4, 2025**.
2. Students who apply for the dormitory at **the second stage** shall download the payment slip on **August 22, 2025 15:00**.

★ Tuition and fee waivers and student loan borrowers shall download and pay the balance bill.



### 3 Deadline for Supplementary Payment of Tuition and Fees

---

03-2652022 Ms. Tien

Paying supplementary tuition and fees can use the following payment methods before September 15, 2025. When payment is overdue, students' admission qualifications will be canceled.

### 4 Payment Methods

---

03-2652224 Ms. Shen

1. **Online payment:** credit card (<https://www.27608818.com/web/tuition>), Taiwan Pay, ATM (please choose the payment function), and International Credit Card (for international students only).
  2. **Paying at a bank counter:** Mega International Commercial Bank, other financial institutions, or convenience stores (payment limitation: NT\$ 60000)
- ★ Payment method details are recorded in the 114-1(2025 Fall Semester) Tuition Fees Announcement.



## 5 Freshman Application for Leave of Absence

**Starts from August 1 to September 15**

03-2651180 Ms.Huang

1. No payment is required to complete the process.
2. Please first go to the “Data Entry Area” on the 新生1網通 to fill in all required data.

★ **Route** <https://fm.cycu.edu.tw/> ,or scan the QR Code

3. Application method: Online application and online review.

★ **Route** CYCU home page → Administrative Unit → Office of Academic Affair → Unit Introduction → Curriculum and Registration Division Administration & services center → Application for Suspension/Resumption /Withdrawal of Study ,or scan the QR Code



### Important Regulations for Suspension of Study:

1. Leave of absence application is limited to one semester at a time and must be completed one month before the end of the current semester or before the start of the next semester. Failure to comply with this regulation may result in expulsion according to Article 52, Clause 4 of the school regulations.
2. Students applying for a leave of absence due to unforeseen circumstances must complete the leave of absence procedure before the start of semester examinations. Grades for the current semester will not be recorded, and the leave of absence period will not be included in the study period, according to Article 49, Clause 3 of the school regulations.
3. Students may apply for a leave of absence ranging from one semester to two academic years. However, periods of leave due to pregnancy, past pregnancy (including induced abortion, miscarriage, or childbirth), caring for children under three years of age, pregnancy of spouse or partner, or past pregnancy of spouse or partner (including induced abortion, miscarriage, or childbirth) are not counted toward the leave of absence period, as per Article 49, Clause 2 of the school regulations.
4. Students on leave of absence who enter military service must present a leave of absence certificate and proof of military service before the original resumption of studies date to apply for an extension of the leave of absence period. Upon completion of military service, they must apply for resumption of studies in accordance with the discharge order. Failure to apply for an extension of leave of absence will result in processing according to Articles 49 and 52. The period of military service is not included in the cumulative leave of absence period (Article 51, Clause 4 of CYCU Academic Policies).
5. Upon resumption of studies, students must enroll in the academic year or semester corresponding to their original study program. (Article 51, Clause 2 of the school regulations)

## 5.Course Selection and Credits Waiver



### Course Selection

03-2652034 Ms. Chiang 03-2652035 Mr. Zheng



Please scan the QR Code on the right for Information about Curriculum and Credits by each department.

### Stage I | Starts from 10:00 P.M. September 4 to 4:00 P.M. September 6.

1. The system will automatically enroll Freshmen students in department-assigned compulsory courses.
2. Students must select General Education basic and elective courses through the Course Selection System by themselves.
3. Freshmen take 'English (I) & (II)' classes, which are mixed across departments and assigned based on their GSAT English scores; those who do not have GSAT or AST scores must take a placement test administered by the Language Center, which will notify the test time and location by email and phone.

★ **Route** CYCU Home page → I-TOUCH → course selection system → enter student number and password

### Stage II | Ends at 8:00 A.M. on September 15.(For all students)

**Common/ Teacher Education Program Courses:** From Sep.8 to Sep.10, 10:00 p.m. to 8:00 a.m. each day

**General Education/ PE/ Military Training Courses:** From Sep.10 to Sep.12, 10:00 p.m. to 8:00 a.m. each day

**All Courses:** Allowed from 10:00 P.M. Sep.12 to 8:00 A.M. Sep.15.

★ Definition of course classification and instructions of inquiry mode can be inquired at the Bulletin Board/System Instructions on the course selection system.

### Course Selection results

During the course selection period, students shall check the "Class Schedule" on the course selection system. At the end of the course selection, students shall check the "Course Selection Information Inquiry" on i-touch.

★ **Route** CYCU Homepage → I-TOUCH(log in) → Study → Teaching website → Convenience learning → Course selection information inquiry

### Exemption from Required English Courses 03-2656551 Ms. Tang

#### Starts from July 30 to September 15

1. Students who meet the English proficiency standards outlined in the university's "Regulations for English Course Exemption" may apply for exemption from required English courses.
2. To apply for exemption, students must submit valid supporting documents to the Language Center before the course withdrawal deadline of each semester.

★ **Route** CYCU Homepage → Academic Units → College of Humanities and Education → The Language Center → Regulation → Apply for English Course Exemption

★ Students who are approved for exemption are required to take alternative courses to make up the exempted credits. Whether these substitute courses may be counted toward graduation credits shall be determined in accordance with the regulations of the respective department or academic program.

### Credits Waiver Starts from August 1 to September 10 03-2652026 Ms. Chan

1. Students who finish studying "CYCU Summer Preparation Programs" or the "National University Advanced Placement Platform" can directly submit the applications without attaching the transcripts.
2. Freshmen who have completed the Ewant Platform: Summer Online School (SOS) shall submit a copy of the certificate of completion and hand it in personally, or send it to the Curriculum and Registration Division of the Academic Affairs Office after the application is submitted.

★ After a new semester starts, shall log in the system and drop the courses which have been allowed to waive credits during the course selection period.

★ **Route** CYCU Homepage → I-TOUCH(log in) → Study → Course selection information → Credits waiver application system

### Guidelines for Make-up Examinations

03-2652032 Ms. Tsa i

1. Students who are unable to attend midterm, graduation, or final exams due to public duties, serious illness, bereavement, or other major accident, must apply for "Exam Leave" online.
2. After leaving approval, students must actively contact the respective course instructor for the make-up exam. The make-up exams will be held by the instructor and be restricted to only one chance per semester. Failure to attend the scheduled make-up examination will result in forfeiture of the opportunity for further make-up.
3. The principle is that those who have approved for make-up exams for graduation or the final exam shall complete the supplementary exam within 7 days after the end of the graduation examination week and 14 days after the end of the semester examination week.



## 6. Student Health Examination

### Physical Check-up for Students

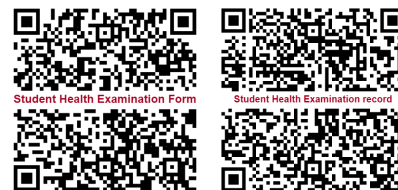

Health Services Division 03-2652162 Ms. Huang

**1. Subject:** New students in the 114-1st semester include returning students, exchange students (**Stays of more than 6 Months**), and transfer students.

**2. Fee:** NTD 600/person

**3. Date:** September 16, 2025 to September 18, 2025  
(08:00am to 04:20pm)(lunch break from 12pm to 1pm)

**4. Venue:** Dickson Lee Hall, 2F. (Tsung Cho-Chang Memorial Hall)

**5. Items:**

- (1) **Physical examination** : Height, Weight, Vision, Waistline, Blood Pressure, Eyes, ENT, Head & Neck, Chest, Abdomen, Spine &limbs, Skin, and Oral Health Screening.
- (2) **Blood test** : Blood Routine, SGOT, SGPT, Total cholesterol, Creatinine, and UA.
- (3) **Urinalysis** : Protein, Sugar, O.B., and pH.
- (4) **Chest X-ray**

**6. Please pay attention to the following points:**

- (1) Log into your i-touch account or scan the QR code labeled Student Health Examination Form above to ensure that you have completed the Student Health Examination Form (CYCU) before **September 30th, 2025**.
- (2) Please complete the health exam within the designated date; only cash payments will be accepted on-site during the health exam.
- (3) Remember not to have an empty stomach before the health examination. Also, avoid staying up later or engaging in intense exercise before the health exam to prevent any potential issues involving the accuracy of the report.
- (4) Please wear a mask throughout the entire exam. If you feel unwell, are currently menstruating, or are pregnant, kindly inform the medical staff beforehand.
- (5) You may check your health examination report on Chi Hsin Clinic website 40 days after the examination date, by scanning the "Student Health Examination record."
- (6) Based on regulations from the Ministry of Education, all students in CYCU must cooperate and participate in the health exam, Refusing to comply with the regulation may cause increased risks or serious illness, and may be involved in improper consequences.
- (7) Chi Hsin Clinic: (Online Reservation Needed)  
Address : 5F, No. 42, Sec. 3, Jianguo N. Rd., Taipei City 104, Taiwan  
Telephone Number : (02)2507-0723 、(02)7709-1119  
Service Time : Mon.to Sat. 8:00-11:00 13:00-16:30
- (8) Physical examination center of Ten-Chan General Hospital (Chung-Li, Reservation by phone needed)  
Address : No 155, Yen-Peng Rd, Chung-Li City, Tao-Yuan County, Taiwan  
Telephone Number : (03)4629292#22000 or 0928-283-172  
Service Time : Mon.to Fri. 8:30-10:00 13:30-16:00
- (9) Contact us if you have any questions:  
Health Services Division of CYCU 03-2652162 /1F, Holistic Education Village

## 7.Our Grants

### Scholarships

03-2652181    [jerrymmt@cycu.edu.tw](mailto:jerrymmt@cycu.edu.tw)

For matters related to Scholarships and Financial Aid for international students, please contact Mr. Fang-Chun Lo at the International and Mainland Students Advising Division, Office of Student Affairs.



### Easy information at CYCU

#### Certificates of enrollment Inquire & Download online

1. Route: Log in to I-TOUCH → Personal Information → Student Profile → Office of Academic Affairs → Enrollment Certificate
2. The certificate of enrollment has already been stamped online. If the certificate needs the official stamp, please print it yourself and go to the Administration & Service Center at Dickson Lee 1F.

#### The transcript of academic record Inquire & Download online

1. Route: Log in to I-TOUCH → Personal Information → Student Profile → Academic records : Log in to I-TOUCH → Study → LEARNING FOOTPRINT → Academic records
2. When requesting an official school stamp on the transcript of Academic records, please print it yourself and go to the Administration and Services Center at 1F of Dickson Lee Hall.
3. "The transcript of academic record" will not be sent a hard copy.

## 8.A different kind of CYCU

### 1 Clubs

For new university students, clubs are not only a way to develop interests, relationships, and horizons, but also a way to learn about group work and creativity. The Extracurricular Activities Unit is located in the Activities Center and offers a wide range of activities each academic year to develop a wide range of skills. There are seven different types of clubs to choose from, including recreational clubs for fun and recreation, musical clubs for artistic pursuits, service clubs with a passion for service, academic clubs for the arts and culture, sports clubs for physical fitness, and social clubs based on the high school district, as well as the departmental clubs for various activities. Do you want to join a club? You are welcome to come closer.

Website: <https://sites.google.com/view/cycustudentclub>



### 2 Part-time Job

To assist students to build up a spirit of independence, expand their horizons and develop a proper working attitude and sense of responsibility. Part-time opportunities are available on campus. Part-time students are required to work on a temporary, specific and transactional work in the school. Students can register online if they have a part-time requirement.

**Path** CYCU Website → I-TOUCH → Log in → Life → Work-Study/Internship world → on Campus Work-Study Registration

The information provided will be used as a reference for all units within the school, and each unit will be responsible for contacting and deciding on the students to be accepted.

### 3 PE Class

CYCU is the only university in Taiwan to host a sports day twice a year. The relay races, and the spirit championship were all part of the program to bring out the enthusiasm and energy of the students. The sports area includes a 50-meter indoor heated swimming pool, tennis courts, badminton courts, basketball courts, a fitness center, etc. There are also many school teams, including athletics, swimming, basketball, volleyball, table tennis, badminton, tennis, bowling, archery, etc., showing that the school attaches importance to the balanced development of students' bodies, mind, and spirit.

**Path** CYCU Website → Administration  
→ Office of Physical Education

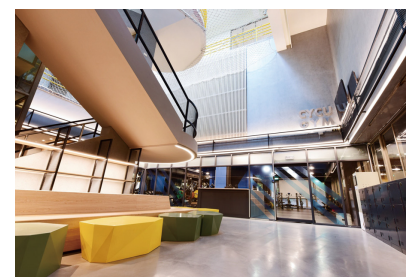



## 4 GENERAL EDUCATION

---

General education activities are integral to the latent curriculum, complementing general education courses. These activities encompass drama, dance, music, arts and culture, thematic film screenings, comprehensive liberal arts forums, and life lectures.

From traditional to modern, local to global, they aim to cultivate an understanding of the present world and achieve the ultimate goal of caring deeply. By integrating humanistic and humanitarian sentiments with devout religious beliefs, participants learn to respect heaven and humanity, adhere to principles, and embody the spirit of the Cosmos, Humanity, Nature, and Self. Highly endorsed by the entire school community, these activities nurture holistic development and cultivate aesthetic appreciation in education.



## 5 FESTIVAL ACTIVITIES

---

Every year, the school organizes a lighting event on Thanksgiving Day, inviting everyone to celebrate the Christmas festivities. Fireworks are set off during the New Year's Eve countdown to celebrate the arrival of the New Year. Through the Mother's Day Choir Competition, we express our love and gratitude to our mothers through song and creativity.



## 6 CYCU Art Salon

In order to promote the value of holistic education and to enhance the form of the personality of truth, goodness, and beauty, Chung Yuan University organizes concerts on Wednesdays and Thursdays during the semester, inviting renowned musicians and performing arts groups from home and abroad to perform.



## 7 Art Center

In view of the inseparable relationship between aesthetic education and personality development, and the importance of arts education to our students, we set up the Art Center in August 2005 to plan and implement arts exhibitions and arts education activities on campus. Each academic year, we present six to eight visual arts exhibitions with a wide variety of themes and media and organize experience workshops to match the themes and creative media. Students who are interested in art are welcome to visit and register for the workshops.





## 9. Parental Online Enquiry

Student Advising Division  
03-2652118 Ms. Yang

### Parent 1 Netcom

Parents of students under 18 are provided with basic information about their children, including transcripts for all semesters, academic records, course list, timetable, leave of absence, student profile, accommodation information, medical examination information, inquiries about tuition, and miscellaneous fees payable, and telephone from relevant authorities.

★ **Route** CYCU Website → Type of website visitor → Parents of students → To enter, please enter the student's number and ID card number (for overseas students, enter the Residence Certificate number) and send the inquiry.



### Student Authorization Process

Students of legal age may log into I-TOUCH, click Personal Information → Agree to open the Parents of Students section, as shown below. After checking the box to authorize, the system will show "V complete the authorization for parental access." After clicking "OK", parents can go to the Parents of Students homepage and enter "Student ID" and "ID Card Number" to access the enquiry.

★ **Route** CYCU homepage → Type of website visitor → Current Students → Login → Personal Information → Agree to open Parents of Students





# 10.CYCU Calendar for Academic Year 2025-2026

| 08<br>AUG | 日  | 一  | 二  | 三  | 四  | 五  | 六  |
|-----------|----|----|----|----|----|----|----|
|           |    |    |    |    |    | 1  | 2  |
|           | 3  | 4  | 5  | 6  | 7  | 8  | 9  |
|           | 10 | 11 | 12 | 13 | 14 | 15 | 16 |
|           | 17 | 18 | 19 | 20 | 21 | 22 | 23 |
|           | 24 | 25 | 26 | 27 | 28 | 29 | 30 |
|           | 31 |    |    |    |    |    |    |

- 01 Beginning of the 1st semester
- 04 Tuition and fees Payment begins / Beginning of application of tuition exemption and loan
- 10 Power off-Regular maintenance of the school power system
- 30 Dormitory open for Freshmen and Current students
- 31 Dormitory open for Freshmen and Current students/Tuition and fees Payment Deadlines for Freshman

| 11<br>NOV | 日  | 一  | 二  | 三  | 四  | 五  | 六  |
|-----------|----|----|----|----|----|----|----|
|           |    |    |    |    |    |    | 1  |
|           | 2  | 3  | 4  | 5  | 6  | 7  | 8  |
|           | 9  | 10 | 11 | 12 | 13 | 14 | 15 |
|           | 16 | 17 | 18 | 19 | 20 | 21 | 22 |
|           | 23 | 24 | 25 | 26 | 27 | 28 | 29 |
|           | 30 |    |    |    |    |    |    |

- 03 - 07 Mid-term Exams
- 10 Beginning of courses withdrawal application / End of application for Double majors / Minors / Interdisciplinary programs / Professional programs /Micro Program
- 14 End of Degree Exams application for Graduate students
- 29 The Teacher-Parent Conference for Freshmen (Offices open)

| 09<br>SEP | 日  | 一  | 二  | 三  | 四  | 五  | 六  |
|-----------|----|----|----|----|----|----|----|
|           |    | 1  | 2  | 3  | 4  | 5  | 6  |
|           | 7  | 8  | 9  | 10 | 11 | 12 | 13 |
|           | 14 | 15 | 16 | 17 | 18 | 19 | 20 |
|           | 21 | 22 | 23 | 24 | 25 | 26 | 27 |
|           | 28 | 29 | 30 |    |    |    |    |

- 01 Career planning workshop for Freshmen, Transfer students / Beginning of Inter-university courses registration (Non-CYCU students)
- 02 Career planning workshop for Freshmen, Transfer students
- 03 Career planning workshop for Freshmen, Transfer students / End of application of tuition exemption and loan / Tuition and fees Payment Deadlines for Current students
- 08 First day of school / Classes begin
- 10 End of credit transfer application for Freshmen and transfer students
- 11 End of Inter-university courses registration(CYCU students and Non-CYCU students)
- 15 Late registration deadline
- 28 Teacher's Day (Holiday)
- 29 Make-up holiday (Teacher's Day holiday)

| 12<br>DEC | 日  | 一  | 二  | 三  | 四  | 五  | 六  |
|-----------|----|----|----|----|----|----|----|
|           |    | 1  | 2  | 3  | 4  | 5  | 6  |
|           | 7  | 8  | 9  | 10 | 11 | 12 | 13 |
|           | 14 | 15 | 16 | 17 | 18 | 19 | 20 |
|           | 21 | 22 | 23 | 24 | 25 | 26 | 27 |
|           | 28 | 29 | 30 | 31 |    |    |    |

- 03 2nd Joint Calculus Examination
- 08 Beginning of online Teaching evaluation
- 10 Course registration for Spring Semester, 2025-2026/ Beginning of Inter-university courses registration (CYCU students)
- 12 End of the course withdrawal application
- 24 Make-up holiday in lieu of the CYCU Sports Day (School and work were suspended)
- 25 Constitution Day (Holiday)
- 31 New Year's Eve celebrations and Flag-raising Ceremony at the Presidential Office on New Year's Day

| 10<br>OCT | 日  | 一  | 二  | 三  | 四  | 五  | 六  |
|-----------|----|----|----|----|----|----|----|
|           |    |    |    | 1  | 2  | 3  | 4  |
|           | 5  | 6  | 7  | 8  | 9  | 10 | 11 |
|           | 12 | 13 | 14 | 15 | 16 | 17 | 18 |
|           | 19 | 20 | 21 | 22 | 23 | 24 | 25 |
|           | 26 | 27 | 28 | 29 | 30 | 31 |    |

- 01 Beginning of application for double majors / minors / Interdisciplinary programs / Professional programs / Micro Program / Teacher's meeting / Beginning of Financial Assistances for Disadvantaged Students / 1st Joint Calculus Examination
- 06 Mid-Autumn festival (Holiday)
- 10 Taiwan National Day (Holiday)
- 15 The University Affairs Meeting / Rehearsal for school anniversary and sports meeting
- 18 School Anniversary celebration / Alumni day / Sports meeting (Offices open)
- 20 Beginning of Degree exam application for Graduate students / End of Financial Assistances for Disadvantaged Students
- 22 CYCU English Assessment
- 24 Make-up Holiday(National Holiday: Taiwan Retrocession and Gunningtou Victory Memorial Day)
- 25 National Holiday:Taiwan Retrocession and Gunningtou Victory Memorial Day(Holiday)

| 01<br>JAN | 日  | 一  | 二  | 三  | 四  | 五  | 六  |
|-----------|----|----|----|----|----|----|----|
|           |    |    |    |    | 1  | 2  | 3  |
|           | 4  | 5  | 6  | 7  | 8  | 9  | 10 |
|           | 11 | 12 | 13 | 14 | 15 | 16 | 17 |
|           | 18 | 19 | 20 | 21 | 22 | 23 | 24 |
|           | 25 | 26 | 27 | 28 | 29 | 30 | 31 |

- 01 New Year's Day (Holiday) / The New Year's flag-raising ceremony
- 02 Application deadline for suspension of studies
- 04 Classes over / End of online Teaching evaluation
- 05 First day to submit grades for all students
- 05 - 09 Final Exams
- 11 Students' dormitory closed (at noon)
- 12 First day of winter vacation /The inquiry for the 2nd semester Tuition and fees Payment begins
- 15 Beginning of application of tuition exemption and loan
- 25 Deadline for Faculty to Submit Grades / Deadline of Make-up Final Exams for Fall Semester, 2025-2026
- 31 End of the 1st semester

# 2026

| 02<br>FEB | 日  | 一  | 二  | 三  | 四  | 五  | 六  |
|-----------|----|----|----|----|----|----|----|
|           | 1  | 2  | 3  | 4  | 5  | 6  | 7  |
|           | 8  | 9  | 10 | 11 | 12 | 13 | 14 |
|           | 15 | 16 | 17 | 18 | 19 | 20 | 21 |
|           | 22 | 23 | 24 | 25 | 26 | 27 | 28 |

- 01 Beginning of the 2nd semester
- 12 Dormitory for the winter term closes
- 16 - 19 Chinese New Year's Eve / Chinese New Year holiday
- 17 Beginning of Inter-university courses registration (Non-CYCU students)
- 18 Tuition & fees Payment Deadlines / End of application of tuition exemption and loan
- 20 Make-up Holiday for the Day Before Chinese New Year's Eve / End day of Winter Vacation
- 21 Dormitory for winter term opens at 12:00
- 23 First day of school / Classes begin
- 25 End of Inter-university courses registration (CYCU students and Non-CYCU students)
- 27 Make-up holiday (Peace Memorial Day)
- 28 Peace Memorial Day (Holiday)

| 03<br>MAR | 日  | 一  | 二  | 三  | 四  | 五  | 六  |
|-----------|----|----|----|----|----|----|----|
|           | 1  | 2  | 3  | 4  | 5  | 6  | 7  |
|           | 8  | 9  | 10 | 11 | 12 | 13 | 14 |
|           | 15 | 16 | 17 | 18 | 19 | 20 | 21 |
|           | 22 | 23 | 24 | 25 | 26 | 27 | 28 |
|           | 29 | 30 | 31 |    |    |    |    |

- 02 Late registration deadline / Beginning of Department transfer application
- 11 Rehearsal for sports meeting
- 16 End of Department transfer application
- 17 - 18 Sports Meeting (No Classes; Offices open)
- 18 - 19 The Academic year 2026-2027 University examination of Disabled students site layout & classroom for check
- 20 - 23 The Academic year 2026-2027 University examination of Disabled students
- 25 Application for Undergraduate Students Studying Master's Degree Program begins/ 1st Joint Calculus Examination

| 04<br>APR | 日  | 一  | 二  | 三  | 四  | 五  | 六  |
|-----------|----|----|----|----|----|----|----|
|           |    |    |    | 1  | 2  | 3  | 4  |
|           | 5  | 6  | 7  | 8  | 9  | 10 | 11 |
|           | 12 | 13 | 14 | 15 | 16 | 17 | 18 |
|           | 19 | 20 | 21 | 22 | 23 | 24 | 25 |
|           | 26 | 27 | 28 | 29 | 30 |    |    |

- 01 Beginning of application for double major / Minor Department / Interdisciplinary programs / Professional programs / Micro Program
- 03 A make-up holiday (Children's Day) (Holiday) / Good Friday
- 04 Children's Day (Holiday)
- 05 Tomb-sweeping Day (Holiday) / Easter day
- 06 A make-up holiday (Tomb-sweeping Day) (Holiday) / Beginning of Degree Exam Application for Graduate Students
- 20 - 24 Mid-term Exams
- 20 Beginning of courses withdrawal application for the Graduating classes
- 27 Beginning of courses withdrawal application for Non-Graduating classes / End of preliminary Graduate student application / Beginning of application for Teacher's education screening
- 29 The University Affairs Meeting

| 05<br>MAY | 日  | 一  | 二  | 三  | 四  | 五  | 六  |
|-----------|----|----|----|----|----|----|----|
|           |    |    |    |    |    | 1  | 2  |
|           | 3  | 4  | 5  | 6  | 7  | 8  | 9  |
|           | 10 | 11 | 12 | 13 | 14 | 15 | 16 |
|           | 17 | 18 | 19 | 20 | 21 | 22 | 23 |
|           | 24 | 25 | 26 | 27 | 28 | 29 | 30 |

31

- 01 Labor Day (Holiday) / End of courses withdrawal application for the graduating classes / End of Degree exam application for Graduate students
- 04 Beginning of Teaching evaluation for Graduating classes
- 08 End of application for Teacher's education screening
- 13 End of application for double major / Minor Department / Interdisciplinary programs / Professional programs / Micro Program
- 20 CYCU English Assessment/ 2nd Joint Calculus exam
- 24 End of Teaching evaluation for Graduating classes
- 25 Beginning of Teaching evaluation for Non-Graduating classes / First day to submit grades of the graduating classes
- 25 - 29 Graduates' Final Exams
- 29 End of courses withdrawal applications for Non-Graduating classes

| 06<br>JUN | 日  | 一  | 二  | 三  | 四  | 五  | 六  |
|-----------|----|----|----|----|----|----|----|
|           |    | 1  | 2  | 3  | 4  | 5  | 6  |
|           | 7  | 8  | 9  | 10 | 11 | 12 | 13 |
|           | 14 | 15 | 16 | 17 | 18 | 19 | 20 |
|           | 21 | 22 | 23 | 24 | 25 | 26 | 27 |
|           | 28 | 29 | 30 |    |    |    |    |

- 05 Rehearsal for the Graduation ceremony
- 06 Graduation ceremony (Office open)
- 07 Deadline to submit grades for the Graduating Classes/ Deadline of Make-up Exam for the Graduates' Final Exam
- 19 Dragon Boat Festival (Holiday) / End of suspension application
- 21 Classes over / End of Teaching evaluations for Non-Graduating classes
- 22 First day to submit grades for all students
- 22 - 26 Final Exams
- 28 End of term stay in Student's dormitory (at noon)
- 29 First day of Summer Vacation (until the end of August 31st, 2026)

| 07<br>JUL | 日  | 一  | 二  | 三  | 四  | 五  | 六  |
|-----------|----|----|----|----|----|----|----|
|           |    |    |    | 1  | 2  | 3  | 4  |
|           | 5  | 6  | 7  | 8  | 9  | 10 | 11 |
|           | 12 | 13 | 14 | 15 | 16 | 17 | 18 |
|           | 19 | 20 | 21 | 22 | 23 | 24 | 25 |
|           | 26 | 27 | 28 | 29 | 30 | 31 |    |

- 01 - 31 Summer course for Academic Year 2025-26 (First phase) Classes Begin
- 12 Deadline for Faculty to Submit Grades/ Deadline of Make-up Final Exams for Spring Semester, 2025-2026
- 22 Course registration for Fall Semester, 2026-2027 / Beginning of Inter-university courses registration (CYCU students)
- 31 End of the 2nd semester
- 8/3 - 28 Summer course for Academic Year 2025-2026 (Second phase) Classes Begin

## 11.Freshmen Orientation Camp



### New students must attend! (Free)

Through programs and activities such as Confidence Building, Service Learning Journey, Campus Adventure, Discovering Self Character, Faculty Experience Camp, Career Mentor Time of Heads of the Department, Instructors, Mentors, and Environmental Service Learning. New students are provided with the necessary information to develop their self-learning skills so they can be enthusiastic about learning new things, exploring new environments and meeting new people, and then choosing their passion.

Student Advising Division 03-2652114 Mr. Chang

### Important Reminders

1. Please enter「新生 1 網通 → 揭開迎新序幕 → 新生學涯體驗營」. For more information on courses and activities, scan the QR code and join each class group.
2. If you are unable to attend the Fresher's Camp for any reason, please follow the path below to complete the leave request procedure and be notified of the make-up day.

★ **Route** CYCU homepage → I-Touch → Login → Personal Information → Student Leave of Absence → Fill in the leave form



## 12. Life and Transportation

Chung Yuan Christian University is close to the Zhongli district, near the train station and the high speed rail station, and is surrounded by excellent living facilities. In addition to the famous Chung Yuan Night Market, there are many brunch shops, mass merchants, cosmetics shops, clothing shops, stationery shops, optical shops, clinics, etc., all of which are convenient for food, clothing, housing and transportation.

### Mailing Address

---

**Please include your dormitory number when sending to the dormitory**

**School Address :** 200 Chung Pei Road, Chung Li District, Taoyuan City, Taiwan 320314, R.O.C.

**Li Hsing Hall (Men's Dormitory):** No. 291, Xinzhong N. Rd., Zhongli Dist., Taoyuan City 320314, Taiwan (R.O.C.)

**Hsin Shih Hall:** No. 210, Puzhong Rd., Zhongli Dist., Taoyuan City 320314, Taiwan (R.O.C.)

**En Tzu Hall (Women's Dormitory):** No. 200, Zhongbei Rd., Zhongli Dist., Taoyuan City 320314, Taiwan (R.O.C.)

**Lian Shan Hall (Women's Dormitory):** No. 200, Zhongbei Rd., Zhongli Dist., Taoyuan City 320314, Taiwan (R.O.C.)

**Re Cheng Hall (Women's Dormitory):** No. 202, Puzhong Rd., Zhongli Dist., Taoyuan City 320314, Taiwan (R.O.C.)

**Re Cheng Hall (Men's Dormitory):** No. 206, Puzhong Rd., Zhongli Dist., Taoyuan City 320314, Taiwan (R.O.C.)

### Mail to Campus Pickup

---

**For the rest, please contact the security desk of each dormitory directly**

**Place:** Please bring your student ID card to the Post Office, Room 106, 1st floor of the Dickson Lee Hall. If you need to collect it on behalf of the student, please bring the photo identification of the representative and the person to be collected.

**Announcement:** Registered mail and parcels should be picked up within 14 days (including holidays) from the announcement date, after which they will be returned. There are announcements on the bulletin board, in front of each department office, and in the dormitories. Students can also check it online.

### Ways to School

---

**1. THSR Station:** Take exit 5 from the 1st floor lobby of THSR Taoyuan station, go to bus platform 5 and take THSR express bus - 170 THSR Taoyuan station - Zhongli. About 20~30 minutes per train, and it takes 20 minutes to reach Zhongli city. Get off at Zhongli Main Station and take a bus to Chung Yuan Christian University.

**2. Taoyuan Bus:** Walk to Taoyuan Bus Terminal and take 155 or 156 to Chung Yuan University.

**3. Zhongli Bus:** Walk to Chungli Bus Terminal and take 167 to Chung Yuan University.

**4. Kuo-Guang Bus:** [1818A] (Every Monday to Friday)

No service during winter and summer vacation and holidays:

1. Taipei Station North Gate 1 - Chung Yuan University 06:30, 07:30, 14:30, 15:30, 16:30

2. Chung Yuan University - Taipei Station North Gate 1 12:20, 14:20, 16:20, 17:20, 18:10

**5. Self-driving:** Please scan the QR CODE on the right.





# 中原大學

Chung Yuan Christian University

## 校園配置圖

Campus Map



自動體外電擊器  
AED



出口  
Gate



停車場入口  
Parking Entry



無障礙通路  
Accessible Routes



機車停車區  
Motorcycle Parking



自行車停車區  
Bicycle Parking



餐廳  
Restaurant

### A 校區 Campus

校門 ①

Main Gate

舊校門 ②

Old Gate

噴水池廣場 ③

Fountain Plaza

懷恩樓 ④

Huai En Hall

維澈樓 ⑤

Dickson Lee Hall

行政大樓 ⑥

Administration Bldg.

十字架鐘塔 ⑦

The Cross and Bell

陸華樓 ⑧

Luh Hwa Hall

真知教學大樓 ⑨

Chen Chih Hall

篤信大樓 ⑩

Tu Hsin Hall

電學大樓 ⑪

Electrical & Computer Eng. Bldg.

智信樓 ⑫

Chih Hsin Hall

恩慈樓 ⑬

Benevolence Hall

良善樓 ⑭

Goodness Hall

建築館 ⑮

Architecture Bldg.

祐生館 ⑯

Yu Sheng Hall

機車停車場 ⑰

Motorcycle Parking Lot

設計學院 ⑱

Design Bldg.

地景建築館 ⑲

Landscape Architecture Bldg.

望樓 ⑳

Wang Hall

室設館 ㉑

Interior Design Bldg.

土木館 ㉒

Civil Engineering Bldg.

莊敬大樓 ㉓

Chuang Ching Hall

工學館 ㉔

Engineering Bldg.

商設館 ㉕

Commercial Design Bldg.

資管樓 ㉖

Information Management Bldg.

管理大樓 ㉗

Management Bldg.

自強商學大樓 ㉘

Tzu Chiang Business Bldg.

恩惠堂 ㉙

Grace Baptist Church

化學館 ㉚

Chemistry Bldg.

理學大樓 ㉛

Science Bldg. II

科學館 ㉜

Science Bldg. I

張靜愚紀念圖書館 ㉝

Chang Ching Yu Memorial Library

全人教育村 ㉞

Holistic Education Village

學生活動中心 ㉟

Student Activities Center

生物科技館 ㊱

Bioscience Technology Bldg.

### B 校區 Campus

游泳池 ㊲

Swimming Pool

力行大樓 ㊳

Li Hsing Hall

體育館 ㊴

Gymnasium

喜樂樓 ㊵

Joy Bldg.

商業設計學系 ㊶

Dept. of Commercial Design

(產品設計組)

(Product Design Division)

忍耐樓 ㊷

Patience Hall

和平樓 ㊸

Amity Hall

仁愛樓 ㊹

Charity Hall

溜冰場 ㊺

Skating Rink

運動園區 ㊻

Sports Park

### C 校區 Campus

薄膜中心(1-3館) ㊼

Membrane Research Center (1-3)

信實樓 ㊽

Faithfulness Hall

水電資設備站 ㊾

Utility Service Station

第一停車場 ㊿

Parking Lot No.1

污水處理場 ㋀

Waste Water Treatment Plant

新中北淨水場 ㋁

Hsin Chung Pei

Water Purification Plant

薄膜中心(4館) ㋂

Membrane Research Center (4)

熱誠樓(A館) ㋃

Re Cheng Hall A

熱誠樓(B館) ㋄

Re Cheng Hall B

知行領航館 ㋅

Chih Hsing Innovation Hall

## Educational Purpose

Chung Yuan Christian University was founded on the basis of Christ's love for the world, and is dedicated to higher education in China with faith, hope, and love. We aim to pursue true knowledge and action, and to serve mankind by inspiring culture.

## Educational Philosophy

We respect the dignity of nature and humanity, seek harmony between the human and the natural, and use our technological and humanistic expertise with wisdom and discretion for the benefit of all people.

We understand that each person is endowed with different talents and has different personalities, abilities, and circumstances, so that the full realization of one's potential is success.

We believe that education is not only a way to explore knowledge and skills, but also a process of building character and pursuing the meaning of one's life.

We believe that love is the guiding force in education, and we are willing to teach by example and with mutual love and respect as teachers and students pursue growth together.

We respect academic freedom and autonomy, and believe that knowledge leads to understanding and understanding leads to freedom.

We believe in the practice of a pragmatic approach to education as a means of seeking true knowledge.

We take pride in the school spirit of reverence for God, love for country, dedication to work, and Advocate to simplicity.

**The light of students is visible to teachers, the light of teacher is visible to God,  
and the light of alumni is visible to the world.**



320314桃園市中壢區中北路200號

No.200, Zhongbei Rd., Zhongli Dist., Taoyuan City 320314, Taiwan (R.O.C.)

TEL: 03-265-9999

FAX: 03-265-8888



Curriculum and Registration Division 03-2652021~2028 Administration and services center 03-2651177~1181

Student Advising Division 03-2652111

Designer LI-TING LIN

Print in June,2025