



中原大學

Chung Yuan Christian University

2026 Spring Semester Newly Admitted Students Handbook

Through an academic foundation and a holistic education process, aiming to cultivate individuals with character, expertise, creativity, and a global perspective.



contents

- 01 Message from the President**
- 02 A Model of Holistic Education**
- 04 Information for New Students**
- 05 Notice for Dormitory Application**
- 06 Data Entry Area**
- 08 Tuition and Miscellaneous Fees**
- 10 Course Selection and Credits Waiver**
- 11 Student Health Examination**
- 12 Our Grants**
- 13 A different kind of CYCU**
- 16 Parental Online Enquiry**
- 17 CYCU Calendar for
Academic Year 2026**
- 18 Life and Transportation**
- 19 Campus Maps**

Message from the President

Dear CYCU freshmen

Greetings and a warm welcome to the CYCU family! As the president of CYCU, it is a great honor to share this special moment with you and to accompany you on this meaningful and enriching journey.

CYCU is now in its 70th year since its establishment in 1955, inspired by a spirit of Christian love for the world. In recent years, the operation of CYCU has won many awards, including a 100% freshmen enrollment rate for the 5th consecutive year, being ranked No.1 in the national and private university for the 7th consecutive year (2018-2024 academic year), being ranked top in private comprehensive universities for the 9th consecutive year. In terms of academic accolades, CYCU was named the Favorite University for Business and the Corporate Favorite University Student by 1111 Job Bank and Global Views Monthly. CYCU also ranked first in graduates' employment rate and high salary for bachelor alumni by 104 Corporation. In 2025, we once again secured the top spot among all private universities in Taiwan in the Global Views Monthly ranking of 'Universities Most Favored by Employers.' We also ranked No. 1 among private universities in the categories of 'Most Favored by Non-Listed Companies' and 'Most Favored by the Information Technology Industry.'

CYCU takes pride in being a sustainable institution with a friendly campus, we were honored by the Ministry of Education in 2019 as an outstanding school and awarded with the "Friendly Campus Award" and "Characteristics School for Life Education Award." In 2023, we were once again awarded the "Friendly Campus Award," making us the first and only school in the nation to be awarded four consecutive times. In addition, CYCU was awarded the "National Sustainable in Education Awards" by the Executive Yuan in 2022 and ranked No.1 among all private Taiwan universities in the UK "QS World University Rankings: Sustainability 2023." The honors show that CYCU has proven our dedication to shouldering social and environmental responsibilities and our commitment to the future. These honors show that CYCU has transformed the core value of holistic education into core competitiveness, which is why it has received various recognitions from the Ministry of Education, business owners, and domestic and international assessments.



We firmly believe that education is not only an approach to exploring knowledge and technique but also the process of shaping one's character and searching for the meaning of our own life. Everyone is endowed with different talents and personalities, abilities, and circumstances; therefore, to realize one's full potential is considered a success. Here at CYCU, you will encounter a wealth of academic resources and a vibrant array of campus activities. We believe that every student is unique, with distinct talents and abilities, and Chung Yuan Christian University is the stage where you can fully realize your potential.

Dear CYCU freshmen, your journey is about to begin. We look forward to seeing you grow through a fulfilling and meaningful university experience, one that will broaden your horizon, deepen your knowledge, and prepare you to become a driving force for positive change in society. Let's support and encourage one another along the way. You got this!

Yours sincerely,

In-Ming Lee



A model of holistic education



The excellence-ranked university in the world, surpassing the national top university

- ★ Ranked No. 1 private comprehensive university for the 6th consecutive year in the Center for World University Rankings (CWUR)
- ★ Ranked No. 1 nationally in the field of Chemical Engineering according to the U.S. News Global University Rankings
- ★ Ranked No. 8 nationally in the fields of “Science” and “Engineering” according to the 2025 Times Higher Education World University Rankings (THE)
- ★ Ranked No. 1 nationally among non-medical private comprehensive universities according to the Times Higher Education Interdisciplinary Science Rankings in 2026



CYCU came out among the top university in academic influence, surpassing the national top university

- ★ The model of Category Normalized Citation Impact (CNCI) in 2024:
Ranked No. 5 among comprehensive universities nationwide in the field of Chemistry
Ranked No. 8 among comprehensive universities nationwide in the field of Engineering
Ranked No. 4 among private comprehensive universities nationwide in the field of Materials Science



Most Favored University by Enterprises No.1 private school in employment rate and high salaries for alumni

- ★ Ranked No. 1 among private universities nationwide for Employer-Favored Graduates Ranking (2025) according to Global Views Monthly
- ★ 104 Corporation ranked CYCU as the No.1 private comprehensive university in the employment rate of graduates
- ★ 104 Corporation ranked CYCU as the private comprehensive university with the highest percentage of alumni salaries above \$80,000



CYCU is Trustworthy by Students and Parents

Quality University with Faith, Hope, and Love



The university with the highest enrollment rate and retention rate

- ★ 100% enrollment rate of freshmen for the 2025 academic year and 100% enrollment rate for the 6th consecutive year
- ★ Ranked No.1 in national and private comprehensive universities in the nation for the 8th consecutive year
- ★ Ranked No.1 in private comprehensive universities for the 10th consecutive year
- ★ Reached 100% enrollment for University Distribution Admissions in the 2025 academic year



No. 1 private school in the industry-academia partnership, comparable to national universities

- ★ Awarded the Industry-Academia Partnership Award by the Chinese Institute of Engineers for the 8th consecutive time, ranked No.1 private university
- ★ The only university in Taiwan awarded International Creative Institution by the Ministry of Economic Affairs
- ★ Awarded the Outstanding Creative Institution by the Small and Medium Enterprise Administration (MOEA) for 12 times
- ★ Awarded one gold, two bronze , and the Best Innovation Award at 2025 The German Nuremberg Invention Exhibition



No. 1 friendly and sustainable campus in the nation

- ★ Awarded the National Sustainable Development Awards by the Executive Yuan in 2022
- ★ Ranked No. 1 among non-medical private universities in Taiwan in the 2026 QS World University Sustainability Rankings
- ★ 2009, 2014, 2019, and 2023 awarded the “Friendly Campus Award” for the four consecutive times by the Ministry of Education, breaking the national record



The highest financial subsidy in Higher Education SPROUT Project for private university

- ★ Received the first prize for the Funding Direction Regarding the Development Plan for Private Universities for the seventh consecutive year, breaking the university record in the nation
- ★ The highest financial subsidy in the MOE Higher Education SPROUT Project for private comprehensive universities in 2020 、2022 、2023.

1.Information for New Students

Student ID



Please scan the QR Code on the right for the student ID or more information.

iTouch for Freshmen

<https://fm.cycu.edu.tw/> Learn more about CYCU and complete all the information.

iTouch <https://www.cycu.edu.tw/> → I-TOUCH

Password Importance and Setup

1. Account and Password Setting:

The account is the student ID number, and the password is preset to 8 codes for the birthday of the West. (Example: 20020102)

Please reset the password after login. The password is valid for six months; if not changed within this period, it will be treated as forgotten and require a reset.

2. Account and Password Security Setting:

CYCU Homepage → I-TOUCH → Login → Personal Information → Account Security Settings (for cellphone number verification)

3.Function Description:

Students can access personal information, for example, basic personal registration, courses, course selection, exams, grades, leave of absence, etc.



Self-checklist

Dormitory Application

☐ Student Housing Division #2191
1/8-1/18

Completing Data Entry Area

☐ Student Advising Division #2128
Open in 1/28

Dormitory Check-in

☐ Student Housing Division #2191
2/21-2/22

Paying for Tuition and Miscellaneous Fees

☐ Cashier Office #2224
1/12-2/18

Students Health Examination

☐ Health Services Division #2162
2/1-3/31

Courses Selection

☐ Please contact each department's office
2/23-3/2

Credit Waiver

☐ Registration and Curriculum Division #2026
1/12-2/23

Applying for Student ID Cards

☐ Registration and Curriculum Division #1178
2/8 before 17:00

TEL (03)265+extension number

2. Notice for Dormitory Application

Dormitory Application

Student Housing division 03-2652191 Ms. Yu



Application Period | Jan 8 - Jan 18

1. Please complete the application before the deadline via the following steps or by scanning the QR Code.

★ **Route** CYCU Homepage → I-TOUCH → Student Dormitory platform → Semester Dormitory Application

2. Lottery Time: Jan. 20 (Manual drawing)

Announce the batch of approved dormitory list at 12:00 on Jan 20.

★ **Enquiry** CYCU Homepage → I-TOUCH → Administrative Proclamation → Announcement of Approved Dormitory List

Dormitory Deposit Payment

1. The tuition fees bill only includes the dormitory fee and air-conditioning prepayment. The dormitory deposit must be paid separately by scanning the QR code provided.

2. International students who can pay the dormitory deposit after moving in must complete the payment within one week of check-in. Those who do not comply will receive a written notification. Such students will lose their priority housing eligibility for the next academic year and will be placed on the written waiting list for a bed.

Dormitory Check-in Time | 12pm, Feb 21 - 5 pm, Feb 22



3.Data Entry Area

1 Go to the Website and Fill out the Data

Beginning on January 28 <https://fm.cycu.edu.tw/>



STEP 1 | Data Entry Area



STEP 2 | Log in

- ★ The account number is the student number, and the password is preset to 8 codes for the birthday of the West.

STEP 3 | The Data Completion Form

The freshmen need to complete all the forms in the Data Completion Form and make sure each section is complete. Feel free to contact the responsible division if there is any question.

2 Completing All the Information in the Data Entry Area

Student personal information in the Data Entry Area is collected for the purpose of contacting students. Student personal information will only be used in school administration and activities. Please follow the description in iTouch for freshmen to fill out and update the information in the Data Entry Area.

The information includes Uploading Life Information Sheet, Dormitory Application, Student ID Application, etc.

- ★ In order to defend personal rights, please make sure the information is correct and complete before submission.

Operating time : 27:42 [Retime](#) [Logout](#)

Help
Teacher's words
Contact

Please click each step below to fill in.

1. Living Data Sheet
2. Application for Student ID Card
3. Application for Financial Account
4. Upload Autobiography
5. Setup of External Email
6. Health Information
7. Student Life Attitudes Survey
8. Summary Table

[Logout](#)

Fill in the operating instructions

Welcome to use the CYCU freshman data filling system.
 The information will be used as the report and basis for the registration of your school registration information during the school year. **Please be sure to fill it out.**
 If you have any questions, please contact the organizer.
 ~~~~The information you fill in will be protected by relevant laws and regulations.~~~~

Homepage Notes:

1. In the life information form: Clicking the "Save" button only stores the data in the temporary database, and you can still modify it within the specified period. If you click the "Confirm and Send" button, it means you have completed filling out the form and confirmed that all the information will no longer be modified. Please double-check before clicking "Confirm and Send".
2. The system has a time limit of 30 minutes for filling out the form. If the time is exceeded, the system will automatically log out. If you haven't completed filling out the form, you can either log in again or click "Restart Timer".

### Student ID Application Registration and Curriculum Division 03-2651178 Ms. Huang

Uploading English name and headshot \*File format: 2M or less clear image file (\*.jpg)

- ★ Completing the application by 17:00 on February 8 (inclusive) can receive the student ID card from the Administration & Services center(Dickson Lee Hall 1F) after February 23.
- ★ Completing the application after 17:00 on February 8 can receive the student ID card from the Administration & Services center(Dickson Lee Hall 1F) after March 9.

## 4. Tuition and Miscellaneous Fees

### 1 Instructions for Paying Tuition and Fees

---

03-2652224 Ms. Shen

Download method for registration bill (includes payment certificate): scan the QR Code on the right side.

★ Log in the Tuition and Fees Area to check the charge standard.



### 2 Payment Deadline

---

From January 12, 2026, to February 18, 2026, students who complete the payment of tuition and fees will be considered registered.

(For alternate students admitted after February 18, 2026, must complete the payment of tuition and fees by **February 23, 2026.**)

Students who apply for the dormitory shall download the payment slip after **January 22, 2026.**

★ Tuition and Fee waivers and students loan borrowers shall download and pay the balance bill.



### 3 Deadline for Supplementary Payment of Tuition and Fees

---

03-2652022 Ms. Tien

Paying supplementary tuition and fees can use the following payment methods to complete the late registration process before March 2, 2026. When payment is overdue, the admission qualifications shall be revoked.

### 4 Payment Methods

---

03-2652224 Ms. Shen

**1. Online payment:** credit card (<https://www.27608818.com/web/tuition>), Taiwan Pay, ATM (please choose the payment function), and International Credit Card (for International Student only).

**2. Paying at a bank counter:** Mega International Commercial Bank, other financial institutions, or the big four convenience stores (payment limitation: NT\$ 60000)

★ Payment method details are recorded in the 114-2(2026) Tuition Fees Announcement.



## 5 Freshman Application for Leave of Absence

### Starts from February 1 to March 2

03-2651180 Ms.Huang

1. No payment is required to complete the process.
2. Please first go to the “Data Entry Area” on the 新生1網通 to fill in all required data.

★ **Route** <https://fm.cycu.edu.tw/> ,or scan the QR Code

3. Application method: Online application and online review.

★ **Route** CYCU home page → Administrative Unit → Office of Academic Affair → Unit Introduction → Curriculum and Registration Division Administration & services center → Application for Suspension/Resumption /Withdrawal of Study ,or scan the QR Code



### Important Regulations for Suspension of Study:

1. Leave of absence application is limited to one semester at a time and must be completed one month before the end of the current semester or before the start of the next semester. Failure to comply with this regulation may result in expulsion, as outlined in the CYCU Academic Policies.
2. Students applying for a leave of absence due to unforeseen circumstances must complete the leave of absence procedure before the start of semester examinations. Grades for the current semester will not be recorded, and the leave of absence period will not be included in the study period.
3. Students may apply for a leave of absence ranging from one semester to two academic years. However, periods of leave due to pregnancy, past pregnancy (including induced abortion, miscarriage, or childbirth), caring for children under three years of age, pregnancy of spouse or partner, or past pregnancy of spouse or partner (including induced abortion, miscarriage, or childbirth) are not counted toward the leave of absence period.
4. Students on leave of absence who enter military service must present a leave of absence certificate and proof of military service before the original resumption of studies date to apply for an extension of the leave of absence period. Upon completion of military service, they must apply for resumption of studies in accordance with the discharge order. Failure to apply for an extension of leave of absence will result in processing according to Articles 49 and 52 of CYCU Academic Policies. The period of military service is not included in the cumulative leave of absence period.
5. Upon resumption of studies, students must enroll in the academic year or semester corresponding to their original study program.

## 5.Course Selection and Credits Waiver



### Course Selection 03-2652034 Ms. Chiang 03-2652035 Mr. Zheng

Please scan the QR Code on the right for Information about Curriculum and Credits by each department.

To add the department-required or elective courses, General Education courses, or Extended General Education electives courses, please contact the respective departments or the General Education Center. Or log in to the course selection system during the 2nd stages Online Course Add/Drop.

★ **Route** CYCU home page → I-TOUCH → course selection system → enter student number and password

### Stage II | Ends at 8:00 A.M. on March 2.(For all students)

**Common/ Teacher Education Program Courses:** Allowed from 10:00 P.M. February 23 to 8:00 A.M. February 24.

**General Education/ PE/ Military Training Courses:** Allowed from 10:00 P.M. February 24 to 8:00 A.M. February 25.

**All Courses:** Allowed from February 25 to March 2, 10:00 p.m. to 8:00 a.m. each day. During the weekend, system will open the whole day.

★ Definition of course classification and instructions of inquiry mode can be inquired at the Bulletin Board/System Instructions on the course selection system.

### Course Selection results

During the course selection period, students shall check the “Class Schedule” on the course selection system. At the end of the course selection, students shall check the “Course Selection Information Inquiry” on I-Touch.

★ **Route** CYCU home page → I-TOUCH → User log-in → Study → Teaching website → convenience learning → course selection information inquiry

### Exemption from Required English Courses

#### Starts from December 17 to February 26

1. Students who meet the English proficiency standards outlined in the university's “Regulations for English Course Exemption” may apply for exemption from required English courses.
2. To apply for exemption, students must submit valid supporting documents to the Language Center before the course withdrawal deadline of each semester.

★ **Route** CYCU Homepage → Academic Units → College of Humanities and Education → The Language Center → Regulation → Apply for English Course Exemption

★ Students who are approved for exemption are required to take alternative courses to make up the exempted credits. Whether these substitute courses may be counted toward graduation credits shall be determined in accordance with the regulations of the respective department or academic program.

### Credits Waiver Starts from January 12 to February 23

03-2652026 Ms. Chan

★ After a new semester starts, students shall log in the system and drop the courses which have been allowed to waive credits during the course selection period.

★ **Route** CYCU home page → I-TOUCH → User log-in → Study → Course selection information → convenience learning → course selection information inquiry

### Guidelines for Requesting Leave and Make-up Examinations

03-2652032 Ms. Tsai

1. Students who are unable to attend midterm, graduation, or final exams due to public duties, serious illness, bereavement, or other major accident, must apply for “Exam Leave” online.
2. After leaving approval, students must actively contact the respective course instructor for the make-up exam. The make-up exams will be held by the instructor and be restricted to only one chance per semester. Failure to attend the scheduled make-up examination will result in forfeiture of the opportunity for further make-up.
3. The principle is that those who have approved for make-up exams for graduation or the final exam shall complete the supplementary exam within 7 days after the end of the graduation examination week and 14 days after the end of the semester examination week.



## 6. Student Health Examination

### Physical Check-up for Students

Health Services Division 03-2652162 Ms. Huang

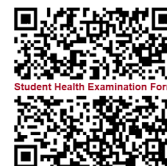

- 1. Object:** New students in the 114-2nd semester include returning students, exchange students ([Staying more than 6 Months](#)), and/or transfer students.
- 2. Fee:** NTD 600/person ([Only Cash payments accepted by medical division](#))
- 3. Date:** February 1, 2026 to March 10, 2026
- 4. Venue:** Chi Hsin Clinic or Ten-Chan General Hospital (Chung-Li)
- 5. Items:**
  - (1) **Physical examination** : Height, Weight, Vision, Waistline, Blood Pressure, Eyes, ENT, Head & Neck, Chest, Abdomen, Spine &limbs, Skin, and Oral Health Screening.
  - (2) **Blood test** : Blood Routine, SGOT, SGPT, Total cholesterol, Creatinine, and UA.
  - (3) **Urinalysis** : Protein, Sugar, O.B., and pH.
  - (4) **Chest X-ray**

#### 6. Please pay attention to the following points:

- (1) Log into your i-touch account or scan the QR code labeled Student Health Examination Form above to ensure that you have completed the Student Health Examination Form (CYCU) before [March 31, 2026](#).
- (2) Please complete the health exam within the designated date; only cash payments will be accepted on-site during the health exam.
- (3) Remember not to have an empty stomach before the health examination. Also, avoid staying up later or engaging in intense exercise before the health exam to prevent any potential issues involving the accuracy of the report.
- (4) Please wear a mask throughout the entire exam. If you feel unwell, are currently menstruating, or are pregnant, kindly inform the medical staff beforehand.
- (5) Starting from [March 11, 2026](#), the medical examination will add an additional fee, the total cost for the examination will be 1000 NT\$. Please complete the student health examination during [Feb 1, 2026 to March 10, 2026](#) to avoid additional fees.
- (6) You may check your health examination report on Chi Hsin Clinic website 40 days after the examination date, by scanning the "Student Health Examination record."
- (7) Based on regulations from the Ministry of Education, all students in CYCU must cooperate and participate in the health exam, Refusing to comply with the regulation may cause increased risks or serious illness, and may be involved in improper consequences.
- (8) Chi Hsin Clinic: (Online Reservation Needed)  
Address : 5F, No. 42, Sec. 3, Jianguo N. Rd., Taipei City 104, Taiwan  
Telephone Number : (02)2507-0723 、(02)7709-1119  
Service Time : Mon.to Sat. 8:00-11:00 13:00-16:30
- (9) Physical examination center of Ten-Chan General Hospital (Chung-Li, Reservation by phone needed)  
Address : No 155, Yen-Peng Rd, Chung-Li City, Tao-Yuan County, Taiwan  
Telephone Number : (03)4278380#2229 or 0928-283-172  
Service Time : Mon.to Fri. 8:00-11:00 13:30-16:00
- (10) Contact us if you have any questions:  
Health Services Division of CYCU 03-2652162 /1F, Holistic Education Village

## 7.Our Grants

### Scholarships

03-2652181    [jerrymmt@cycu.edu.tw](mailto:jerrymmt@cycu.edu.tw)

For matters related to Scholarships and Financial Aid for international students, please contact Mr. Fang-Chun Lo at the International and Mainland Students Advising Division, Office of Student Affairs.



### Easy information at CYCU

#### Certificates of enrollment Inquire & Download online

1. Route: Log in to I-TOUCH → Personal Information → Student Profile →Office of Academic Affairs →Enrollment Certificate
2. The certificate of enrollment has already been stamped online. If the certificate needs the official stamp, please print it yourself and go to the Administration & Service Center at Dickson Lee 1F.

#### The transcript of academic record Inquire & Download online

1. Route: Log in to I-TOUCH → Personal Information → Student Profile → Academic records : Log in to I-TOUCH → Study → LEARNING FOOTPRINT→ Academic records
2. When requesting an official school stamp on the transcript of Academic records, please print it yourself and go to the Administration and Services Center at 1F of Dickson Lee Hall.
3. "The transcript of academic record" will not be sent a hard copy.

## 8.A different kind of CYCU

### 1 Clubs

For new university students, clubs are not only a way to develop interests, relationships, and horizons, but also a way to learn about group work and creativity. The Extracurricular Activities Unit is located in the Activities Center and offers a wide range of activities each academic year to develop a wide range of skills. There are seven different types of clubs to choose from, including recreational clubs for fun and recreation, musical clubs for artistic pursuits, service clubs with a passion for service, academic clubs for the arts and culture, sports clubs for physical fitness, and social clubs based on the high school district, as well as the departmental clubs for various activities. Do you want to join a club? You are welcome to come closer.

Website : <https://sites.google.com/view/cycustudentclub>



### 2 Part-time Job

To assist students to build up a spirit of independence, expand their horizons and develop a proper working attitude and sense of responsibility. Part-time opportunities are available on campus. Part-time students are required to work on a temporary, specific and transactional work in the school. Students can register online if they have a part-time requirement.

**Path** CYCU Website → I-TOUCH → Log in → Life → Work-Study/Internship world → on Campus Work-Study Registration

The information provided will be used as a reference for all units within the school, and each unit will be responsible for contacting and deciding on the students to be accepted.

### 3 PE Class

CYCU is the only university in Taiwan to host a sports day twice a year. The relay races, and the spirit championship were all part of the program to bring out the enthusiasm and energy of the students. The sports area includes a 50-meter indoor heated swimming pool, tennis courts, badminton courts, basketball courts, a fitness center, etc. There are also many school teams, including athletics, swimming, basketball, volleyball, table tennis, badminton, tennis, bowling, archery, etc., showing that the school attaches importance to the balanced development of students' bodies, mind, and spirit.

**Path** CYCU Website → Administration  
→ Office of Physical Education

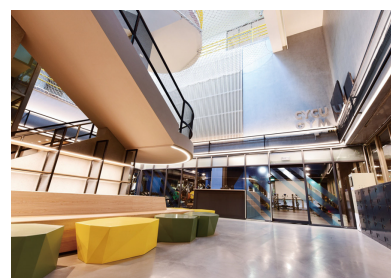



## 4 GENERAL EDUCATION

Activities of general education are integral to the latent curriculum, complementing general education courses. These activities encompass drama, dance, music, arts and culture, thematic film screenings, comprehensive liberal arts forums, and life lectures.

From traditional to modern, local to global, they aim to cultivate an understanding of the present world and achieve the ultimate goal of caring deeply. By integrating humanistic and humanitarian sentiments with devout religious beliefs, participants learn to respect heaven and humanity, adhere to principles, and embody the spirit of the Creator, Humanity, Entire Creation, and Individual Self. Highly endorsed by the entire school community, these activities nurture holistic development and cultivate aesthetic appreciation in education.



## 5 FESTIVAL ACTIVITIES

Every year, the school organizes a lighting event on Thanksgiving Day, inviting everyone to celebrate the Christmas festivities. Fireworks are set off during the New Year's Eve countdown to celebrate the arrival of the New Year. Through the Mother's Day Choir Competition, we express our love and gratitude to our mothers through song and creativity.



## 6 CYCU Art Salon

---

In order to promote the value of holistic education and to enhance the form of the personality of truth, goodness, and beauty, Chung Yuan University organizes concerts on Wednesdays and Thursdays during the semester, inviting renowned musicians and performing arts groups from home and abroad to perform.



## 7 Art Center

---

In view of the inseparable relationship between aesthetic education and personality development, and the importance of arts education to our students, we set up the Art Center in August 2005 to plan and implement arts exhibitions and arts education activities on campus. Each academic year, we present six to eight visual arts exhibitions with a wide variety of themes and media and organize experience work-shops to match the themes and creative media. Students who are interested in art are welcome to visit and register for the workshops.





## 9. Parental Online Enquiry

Student Advising Division  
03-2652118 Ms. Yang

### Parent 1 Netcom

Parents of students under 18 are provided with basic information about their children, including transcripts for all semesters, academic records, course list, timetable, leave of absence, student profile, accommodation information, medical examination information, inquiries about tuition, and miscellaneous fees payable, and telephone from relevant authorities.

- ★ **Route** CYCU Website → Type of website visitor → Parents of students → To enter, please enter the student's number and ID card number (for overseas students, enter the Residence Certificate number) and send the inquiry.



### Student Authorization Process

Students of legal age may log into I-TOUCH, click Personal Information → Agree to open the Parents of Students section, as shown below. After checking the box to authorize, the system will show "V complete the authorization for parental access." After clicking "OK", parents can go to the Parents of Students homepage and enter "Student ID" and "ID Card Number" to access the enquiry.

- ★ **Route** CYCU homepage → Type of website visitor → Current Students → Login → Personal Information → Agree to open Parents of Students





# 10.CYCU Calendar for Academic Year 2026



| 日  | 一  | 二  | 三  | 四  | 五  | 六  |
|----|----|----|----|----|----|----|
| 1  | 2  | 3  | 4  | 5  | 6  | 7  |
| 8  | 9  | 10 | 11 | 12 | 13 | 14 |
| 15 | 16 | 17 | 18 | 19 | 20 | 21 |
| 22 | 23 | 24 | 25 | 26 | 27 | 28 |

- 01 Beginning of the 2nd semester
- 12 Dormitory for the winter term closes
- 16 – 19 Chinese New Year's Eve / Chinese New Year holiday
- 17 Beginning of Inter-university courses registration (Non-CYCU students)
- 18 Tuition & fees Payment Deadlines / End of application of tuition exemption and loan
- 20 Make-up Holiday for the Day Before Chinese New Year's Eve / End day of Winter Vacation
- 21 Dormitory for winter term opens at 12:00
- 23 First day of school / Classes begin
- 25 End of Inter-university courses registration(CYCU students and Non-CYCU students)
- 27 Make-up holiday (Peace Memorial Day)
- 28 Peace Memorial Day (Holiday)

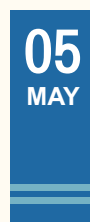

| 日  | 一  | 二  | 三  | 四  | 五  | 六  |
|----|----|----|----|----|----|----|
|    |    |    |    |    | 1  | 2  |
| 3  | 4  | 5  | 6  | 7  | 8  | 9  |
| 10 | 11 | 12 | 13 | 14 | 15 | 16 |
| 17 | 18 | 19 | 20 | 21 | 22 | 23 |
| 24 | 25 | 26 | 27 | 28 | 29 | 30 |
| 31 |    |    |    |    |    |    |

- 01 Labor Day (Holiday) / End of courses withdrawal application for the graduating classes / End of Degree exam application for Graduate students
- 04 Beginning of Teaching evaluation for Graduating classes
- 08 End of application for Teacher's education screening
- 13 End of application for double major / Minor Department / Interdisciplinary programs / Professional programs / Micro Program
- 20 CYCU English Assessment/ 2nd Joint Calculus exam
- 24 End of Teaching evaluation for Graduating classes
- 25 Beginning of Teaching evaluation for Non-Graduating classes / First day to submit grades of the graduating classes
- 25 – 29 Graduates' Final Exams
- 29 End of courses withdrawal applications for Non-Graduating classes



| 日  | 一  | 二  | 三  | 四  | 五  | 六  |
|----|----|----|----|----|----|----|
| 1  | 2  | 3  | 4  | 5  | 6  | 7  |
| 8  | 9  | 10 | 11 | 12 | 13 | 14 |
| 15 | 16 | 17 | 18 | 19 | 20 | 21 |
| 22 | 23 | 24 | 25 | 26 | 27 | 28 |
| 29 | 30 | 31 |    |    |    |    |

- 02 Late registration deadline / Beginning of Department transfer application
- 11 Rehearsal for sports meeting
- 16 End of Department transfer application
- 17 – 18 Sports Meeting(No Classes; Offices open)
- 18 – 19 The Academic year 2026-2027 University examination of Disabled students site layout & classroom for check
- 20 – 23 The Academic year 2026-2027 University examination of Disabled students
- 25 Application for Undergraduate Students Studying Master's Degree Program begins/ 1st Joint Calculus Examination



| 日  | 一  | 二  | 三  | 四  | 五  | 六  |
|----|----|----|----|----|----|----|
|    | 1  | 2  | 3  | 4  | 5  | 6  |
| 7  | 8  | 9  | 10 | 11 | 12 | 13 |
| 14 | 15 | 16 | 17 | 18 | 19 | 20 |
| 21 | 22 | 23 | 24 | 25 | 26 | 27 |
| 28 | 29 | 30 |    |    |    |    |

- 05 Rehearsal for the Graduation ceremony
- 06 Graduation ceremony (Office open)
- 07 Deadline to submit grades for the Graduating Classes/ Deadline of Make-up Exam for the Graduates' Final Exam
- 19 Dragon Boat Festival (Holiday) / End of suspension application
- 21 Classes over / End of Teaching evaluations for Non-Graduating classes
- 22 First day to submit grades for all students
- 22 – 26 Final Exams
- 28 End of term stay in Student's dormitory (at noon)
- 29 First day of Summer Vacation (until the end of August 31st, 2026)



| 日  | 一  | 二  | 三  | 四  | 五  | 六  |
|----|----|----|----|----|----|----|
|    |    |    | 1  | 2  | 3  | 4  |
| 5  | 6  | 7  | 8  | 9  | 10 | 11 |
| 12 | 13 | 14 | 15 | 16 | 17 | 18 |
| 19 | 20 | 21 | 22 | 23 | 24 | 25 |
| 26 | 27 | 28 | 29 | 30 |    |    |

- 01 Beginning of application for Double major / Minor Department / Interdisciplinary programs / Professional programs / Micro Program
- 03 A make-up holiday (Children's Day) (Holiday) / Good Friday
- 04 Children's Day (Holiday)
- 05 Tomb-sweeping Day (Holiday) / Easter day
- 06 A make-up holiday (Tomb-sweeping Day) (Holiday) / Beginning of Degree Exam Application for Graduate Students
- 20 – 24 Mid-term Exams
- 20 Beginning of courses withdrawal application for the Graduating classes
- 27 Beginning of courses withdrawal application for Non-Graduating classes / End of preliminary Graduate student application / Beginning of application for Teacher's education screening
- 29 The University Affairs Meeting



| 日  | 一  | 二  | 三  | 四  | 五  | 六  |
|----|----|----|----|----|----|----|
|    |    |    | 1  | 2  | 3  | 4  |
| 5  | 6  | 7  | 8  | 9  | 10 | 11 |
| 12 | 13 | 14 | 15 | 16 | 17 | 18 |
| 19 | 20 | 21 | 22 | 23 | 24 | 25 |
| 26 | 27 | 28 | 29 | 30 | 31 |    |

- 01 – 31 Summer course for Academic Year 2025-26 (First phase) Classes Begin
- 12 Deadline for Faculty to Submit Grades/ Deadline of Make-up Final Exams for Spring Semester, 2025-2026
- 22 Course registration for Fall Semester, 2026-2027 / Beginning of Inter-university courses registration (CYCU students)
- 31 End of the 2nd semester
- 8/3 – 28 Summer course for Academic Year 2025-2026 (Second phase) Classes Begin

## 11. Life and Transportation

Chung Yuan Christian University is close to the Zhongli district, near the train station and the high speed rail station, and is surrounded by excellent living facilities. In addition to the famous Chung Yuan Night Market, there are many brunch shops, mass merchants, cosmetics shops, clothing shops, stationery shops, optical shops, clinics, etc., all of which are convenient for food, clothing, housing and transportation.

### Mailing Address

---

**Please include your dormitory number when sending to the dormitory**

**School Address :** 200 Chung Pei Road, Chung Li District, Taoyuan City, Taiwan 320314, R.O.C.

**Li Hsing Hall (Men's Dormitory):** No. 291, Xinzhong N. Rd., Zhongli Dist., Taoyuan City 320314, Taiwan (R.O.C.)

**Hsin Shih Hall:** No. 210, Puzhong Rd., Zhongli Dist., Taoyuan City 320314, Taiwan (R.O.C.)

**En Tzu Hall (Women's Dormitory):** No. 200, Zhongbei Rd., Zhongli Dist., Taoyuan City 320314, Taiwan (R.O.C.)

**Lian Shan Hall (Women's Dormitory):** No. 200, Zhongbei Rd., Zhongli Dist., Taoyuan City 320314, Taiwan (R.O.C.)

**Re Cheng Hall (Women's Dormitory):** No. 202, Puzhong Rd., Zhongli Dist., Taoyuan City 320314, Taiwan (R.O.C.)

**Re Cheng Hall (Men's Dormitory):** No. 206, Puzhong Rd., Zhongli Dist., Taoyuan City 320314, Taiwan (R.O.C.)

### Mail to Campus Pickup

---

**For the rest, please contact the security desk of each dormitory directly**

**Place:** Please bring your student ID card to the Post Office, Room 106, 1st floor of the Dickson Lee Hall. If you need to collect it on behalf of the student, please bring the photo identification of the representative and the person to be collected.

**Announcement:** Registered mail and parcels should be picked up within 14 days (including holidays) from the announcement date, after which they will be returned. There are announcements on the bulletin board, in front of each department office, and in the dormitories. Students can also check it online.

### Ways to School

---

**1. THSR Station:** Take exit 5 from the 1st floor lobby of THSR Taoyuan station, go to bus platform 5 and take THSR express bus - 170 THSR Taoyuan station - Zhongli. About 20~30 minutes per train, and it takes 20 minutes to reach Zhongli city. Get off at Zhongli Main Station and take a bus to Chung Yuan Christian University.

**2. Taoyuan Bus:** Walk to Taoyuan Bus Terminal and take 155 or 156 to Chung Yuan University.

**3. Zhongli Bus:** Walk to Chungli Bus Terminal and take 167 to Chung Yuan University.

**4. Kuo-Guang Bus:** [1818A] (Every Monday to Friday)

No service during winter and summer vacation and holidays:

1. Taipei Station North Gate 1 - Chung Yuan University 06:40, 07:30, 14:30, 15:30

2. Chung Yuan University - Taipei Station North Gate 1 12:20, 14:20, 16:20, 17:20

**5. Self-driving:** Please scan the QR CODE on the right.





## 校園配置圖

Campus Map



### A 校區 Campus

- |                                |                                            |                                         |                                                |
|--------------------------------|--------------------------------------------|-----------------------------------------|------------------------------------------------|
| 校門 ①<br>Main Gate              | 篤信大樓 ⑩<br>Tu Hsin Hall                     | 地景建築館 ⑬<br>Landscape Architecture Bldg. | 自強商學大樓 ②⑧<br>Tzu Chiang Business Bldg.         |
| 舊校門 ②<br>Old Gate              | 電學大樓 ⑪<br>Electrical & Computer Eng. Bldg. | 望樓 ②⑩<br>Wang Hall                      | 恩惠堂 ②⑨<br>Grace Baptist Church                 |
| 噴水池廣場 ③<br>Fountain Plaza      | 智信樓 ⑫<br>Chih Hsin Hall                    | 室設館 ②⑪<br>Interior Design Bldg.         | 化學館 ③⑩<br>Chemistry Bldg.                      |
| 懷恩樓 ④<br>Hwai En Hall          | 恩慈樓 ⑬<br>Benevolence Hall                  | 土木館 ②②<br>Civil Engineering Bldg.       | 理學大樓 ③①<br>Science Bldg. II                    |
| 維澈樓 ⑤<br>Dickson Lee Hall      | 良善樓 ⑭<br>Goodness Hall                     | 莊敬大樓 ②③<br>Chuang Ching Hall            | 科學館 ③②<br>Science Bldg. I                      |
| 行政大樓 ⑥<br>Administration Bldg. | 建築館 ⑮<br>Architecture Bldg.                | 工學館 ②④<br>Engineering Bldg.             | 張靜愚紀念圖書館 ③③<br>Chang Ching Yu Memorial Library |
| 十字架鐘塔 ⑦<br>The Cross and Bell  | 祐生館 ⑮<br>Yu Sheng Hall                     | 商設館 ②⑤<br>Commercial Design Bldg.       | 全人教育村 ③④<br>Holistic Education Village         |
| 陸華樓 ⑧<br>Luh Hwa Hall          | 機車停車場 ⑮<br>Motorcycle Parking Lot          | 資管樓 ②⑥<br>Information Management Bldg.  | 學生活動中心 ③⑤<br>Student Activities Center         |
| 真知教學大樓 ⑨<br>Chen Chih Hall     | 設計學院 ⑮<br>Design Bldg.                     | 管理大樓 ②⑦<br>Management Bldg.             | 生物科技館 ③⑥<br>Bioscience Technology Bldg.        |

### B 校區 Campus

- |                                                                        |                        |
|------------------------------------------------------------------------|------------------------|
| 游泳池 ⑤⑦<br>Swimming Pool                                                | 溜冰場 ④⑤<br>Skating Rink |
| 力行大樓 ③⑧<br>Li Hsing Hall                                               | 運動園區 ④⑥<br>Sports Park |
| 體育館 ③⑨<br>Gymnasium                                                    |                        |
| 喜樂樓 ④⑩<br>Joy Bldg.                                                    |                        |
| 商業設計學系 (產品設計組)<br>Dept. of Commercial Design (Product Design Division) |                        |
| 忍耐樓 ④②<br>Patience Hall                                                |                        |
| 和平樓 ④③<br>Amity Hall                                                   |                        |
| 仁愛樓 ④④<br>Charity Hall                                                 |                        |

### C 校區 Campus

- |                                                      |                                        |
|------------------------------------------------------|----------------------------------------|
| 薄膜中心 (1~3館) ④⑦<br>Membrane Research Center (1-3)     | 智慧領航方舟 ⑤⑥<br>Wisdom Innovation Ark     |
| 信實樓 ④⑧<br>Faithfulness Hall                          | 知行領航館 ⑤⑦<br>Chih Hsing Innovation Hall |
| 水電資設備站 ④⑨<br>Utility Service Station                 | 實英樓 ⑤⑧<br>Unixtar Hall                 |
| 第一停車場 ⑤⑩<br>Parking Lot No. 1                        |                                        |
| 污水處理場 ⑤①<br>Waste Water Treatment Plant              |                                        |
| 新中北淨水場 ⑤②<br>Hsin Chung Pei Water Purification Plant |                                        |
| 薄膜中心 (4館) ⑤③<br>Membrane Research Center (4)         |                                        |
| 熱誠樓 (A館) ⑤④<br>Re Cheng Hall A                       |                                        |
| 熱誠樓 (B館) ⑤⑤<br>Re Cheng Hall B                       |                                        |



## Educational Purpose

Chung Yuan Christian University was founded on the basis of Christ's love for the world, and is dedicated to higher education in China with faith, hope, and love. We aim to pursue true knowledge and action, and to serve mankind by inspiring culture.

## Educational Philosophy

We respect the dignity of nature and humanity, seek harmony between the human and the natural, and use our technological and humanistic expertise with wisdom and discretion for the benefit of all people.

We understand that each person is endowed with different talents and has different personalities, abilities, and circumstances, so that the full realization of one's potential is success.

We believe that education is not only a way to explore knowledge and skills, but also a process of building character and pursuing the meaning of one's life

We believe that love is the guiding force in education, and we are willing to teach by example and with mutual love and respect as teachers and students pursue growth together.

We respect academic freedom and autonomy, and believe that knowledge leads to understanding and understanding leads to freedom.

We believe in the practice of a pragmatic approach to education as a means of seeking true knowledge.

We take pride in the school spirit of reverence for God, love for country, dedication to work, and Advocate to simplicity.

**The light of students is visible to teachers, the light of teacher is visible to God,  
and the light of alumni is visible to the world.**



320314桃園市中壢區中北路200號

No.200, Zhongbei Rd., Zhongli Dist., Taoyuan City 320314, Taiwan (R.O.C.)

TEL : 03-265-9999

FAX: 03-265-8888

Curriculum and Registration Division 03-2652021~2028 Administration and services center 03-2651177~1181

Student Advising Division 03-2652111

Designer LI-TING LIN

Print in January, 2025